



NEXT DIMENSION VINYL WINDOWS BY WINDSOR WINDOWS & DOORS

900 S. 19th Street
West Des Moines, IA 50265
(515) 223-6660

2210 Stafford St. Extn.
Monroe, NC 28110
(704) 283-7459

INSTALLATION INSTRUCTIONS:

1. Make sure rough opening is correctly sized, and is level, plumb and square.

2. Apply return covers and jamb extensions (if used) to window and door units as described in the "Drywall/Jamb Extension Return" section. Jamb extension is shipped loose to prevent damage during shipment.

3. Apply a bead of silicone caulk around exterior face of rough opening, about 1/2" from edge, as shown.

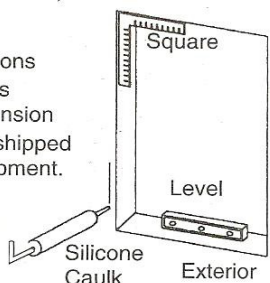

4. Set window into opening. Shim under sill and along sides to make unit level and square. Do not over or under-shim. **Important:** Window must be uniformly supported along full length of the sill. DO NOT suspend unit from head nailing fin. Failure to adequately support sill can result in improper sash operation and **VOID WARRANTY.**

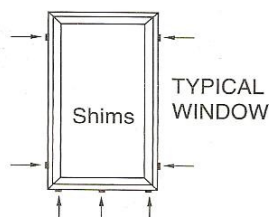

5. **FOR DOUBLE HUNG UNITS:**
TO ENSURE PROPER WINDOW OPERATION AND PERFORMANCE, IT IS VERY IMPORTANT TO SHIM THE MIDDLE OF THE UNIT TO OBTAIN EQUAL FRAME WIDTHS AS SHOWN.

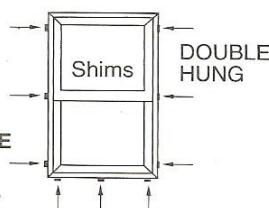

6. Nail through pre-punched holes with 2" roofing nails to anchor unit to sheathing. Note: Installation conditions may vary, requiring different fasteners or methods.

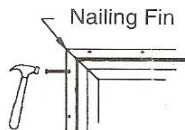

7. It is recommended to nail through the nailing fin. The proper attachment is shown in the drawing to the right. **Method 1** is to nail over the nail fin and bend the nail over on the nail fin. **Method 2** is to use a cap nail that incorporates a large plastic washer that will overlap the nail fin. This will ensure that the door does not bind under possible pressure from header sag and or settling of structure.

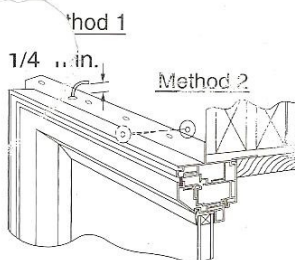

8. After siding has been installed, apply a bead of caulking or sealant between siding or J-channel and the frame of the window/door to seal unit in opening.

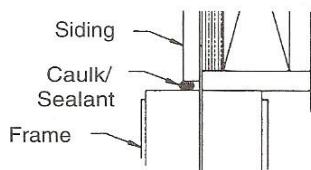

9. Check installation and sash/panel operation before trimming interior. **Sash will not operate smoothly if unit is out of square, over-shimmed, or over-insulated.**

DRYWALL/JAMB EXTENSION RETURN

1. Place a small bead of sealant around the perimeter of the frame in the recess shown.

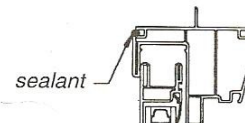

2. Install the 3" Jamb extension clips around the perimeter of the frame, two on each corner, and then spaced on approximate 18" intervals along the frame.

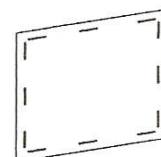

3. Position the Jamb extension as shown against the clips and staple or screw through the clip into the back side of the Jamb extension.

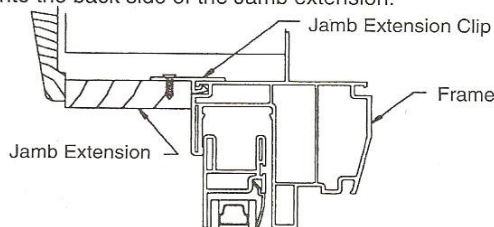

4. Measure overall interior frame width and height. An example of wrap around jamb extension application is shown below.

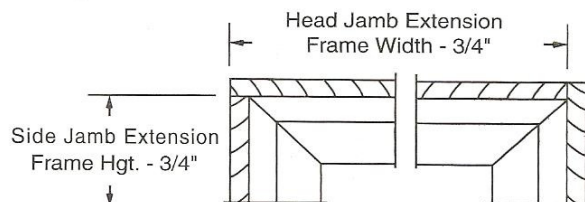

CARE & MAINTENANCE

1. Do not paint, stain or varnish any vinyl surface.
2. Clean window frame and sash with vinyl cleaning products or soap and water only.
3. In case of a deep scratch, lightly buff with ultra-fine sandpaper, then apply automotive rubbing compound.

WARRANTY

Copy of Lifetime Limited product warranty available at your local supplier.

LABEL REMOVAL:

JUST GENTLY "PEEL AWAY"! NO SCRAPING NEEDED!